

Torino194

Digital Signage indoor kiosk



- ✓ Large 19" LCD display with LED backlight
- ✓ Glove capable touchscreen functionality
- ✓ Solid painted steel structure
- ✓ Many solutions available for vandal proof keyboard & barcode reader
- ✓ Integrated speakers for multimedia contents diffusion
- ✓ Available with customer accessible USB port
- ✓ LAN & WiFi connectivity
- ✓ High processing capacity thanks to Intel® Core™ processors





Technical specifications

System	Processor	Socket LGA 1151 Intel® Core™ from 6 th to 9 th gen. Intel® Core™ i7 / Core™ i5 / Core™ i3 / Pentium	
	Chipset	Intel® H310 Express Chipset	
	BIOS	1 x 128 Mb AMI UEFI BIOS PnP 1.0a, DMI 2.7, WfM 2.0, SM BIOS 2.7, ACPI 5.0	
	Expansion slots	1 x PCI Express 3.0 x16 2 x PCI Express 2.0 x1	
	Memoria	Max exp.	32GB
Type		DDR4- 2666/2400/2133 UDIMM 288pin 4GB, 8GB, 16GB	
Slots		2	
Customer I/O interface	USB	1 x USB 2.0 optional	
Internal I/O interface*	Note	*Some I/O interfaces are used by internal devices	
	Serial	N/A	
	LPT	N/A	
	USB		4 x USB 2.0 2 x USB 3.1 gen.1 2 x USB 3.1 gen.1 optional
		Mouse/keyboard	2 x PS/2
		Audio	3 x Jack 3.5mm (Line In, Line Out, Mic In)
	Video		1 x VGA DB15 1 x DVI-D 1 x HDMI
		LAN	1 x RJ45
		Storage	Integrated SATA ctrl
	HDD/SSD bay		1 x 3.5"
Video subsystem	Integrated video adapter		Intel® HD Graphics Features depend on installed CPU
	LCD Display	19.0" TFT	
	Color	16.7M	
	Viewing angle	H: 176° V: 170°	
	Response time	5ms	
	Brightness	250 cd/m ²	
	Contrast	1000:1	
	Reccomended res.	1280x1024	
	Touchscreen	Yes (see ordering code)	
	Audio subsystem	Integrated audio adapter	7.1 High Definition Audio (Codec Realtek® ALC887)
Speaker		2 x Integrated speakers	

Network interface	Integrated network adapter	1 x 10/100/1000 Realtek® GbE LAN
	WiFi (optional)	1 x Wireless High Gain N 150Mbps USB IEEE 802.11n, IEEE 802.11g, IEEE 802.11b
Power	Standard PSU	AC INPUT: 100-240V, 60-50Hz
Software	Supported operating system	Microsoft Windows 10 64bit
Machanical features	Colour	Standard color : See ordering code. Optional: Different colors on request, subject to availability and minimum purchase quantity is required.
	L x H x D	510mm x 1435mm x 460mm (without keyboard) 510mm x 1435mm x 616mm (with keyboard)
	Weight	Estimated 55Kg for medium configuration
Environment	Operating temp	From + 5°C to + 35°C
	Non operating temp.	From -30°C to +70°C
Certifications	RH	95% @ 30°C non cond.
	Reference Marks	CE, RoHS
	Directive	Built according to EU Directive 2014/30/EU(EMCD), 2014/35/EU(LVD) or 2014/53/UE (RED) for WiFi equipped product. & 2011/65/EU(RoHS)
Company cert.	Reference std.	UNI EN ISO 9001
	Doc. code	ZST-4292-00000060-02





 **Scan me**

Intercomp S.p.A.
Via della Scienza 27, 37139, Verona, Italia
Tel +39 045-8378411 Fax +39 045-8510539
www.intercomp.it intercomp@intercomp.it

The product may differ from the images shown. All registered names and trademarks are legitimate owners. All features and specifications can be changed without prior notice.
Last update 04/05/2020



Ordering code & Kit specifications

Totem Torino194	Ordering code	CNTOTEM19P-H-19-03AT
	Features	Base configuration* + EKIT-17-000006A-00 Single touch touchscreen included Color : Gray metallic wrinkled (66024 IN) *See previous page for detailed information.

Choice notice → **One of the following LCD kits must be chosen**

LCD & Touch opt1	Ordering code	EKIT-17-000006A-00 (default installed in base config.)
	Features	Standard LCD panel : 19" (see previous pages) Touchscreen : SAW 1 touch touchscreen Protection glass : Yes

LCD & Touch opt2	Ordering code	EKIT-17-000007A-00*
	Features	Standard LCD panel : 19" (see previous pages) Touchscreen : IR 4 touch touchscreen Protection glass : Yes

LCD w/o Touch Opt3	Ordering code	EKIT-17-000005A-00*
	Features	Standard LCD panel : 19" (see previous pages) Touchscreen : NO Protection glass : Yes

WiFi	Ordering code	EKIT-IND-WIFI-005A*
	Features	USB Wireless N 150Mbps High Gain Standard : IEEE 802.11b/g/n Freq. : 2.400-2.4835GHz Signal rate : 11n: Up to 150Mbps(dynamic) 11g: Up to 54Mbps(dynamic) 11b: Up to 11Mbps(dynamic)

Customer USB	Ordering code	EKIT-TOTEM-ACC-0048*
	Features	1 x USB 2.0 Right side customer accessible USB port. Protected by rubber cap.

Keyboard	Ordering code	EKIT-TOTEM-ACC-0011*
	Features	Kiosk keyboard kit : 66 keys, Trackball + 3 mouse button, IP65, vandal proof, IT layout, w/o ctrl-alt-del keys

	Ordering code	EKIT-TOTEM-ACC-0012*
	Features	Kiosk keyboard kit : 66 keys, Trackball + 3 mouse button, IP65, vandal proof, IT layout, with ctrl-alt-del keys

Choice notice → **The barcode kit can be chosen in combination with keyboard kit**

Barcode reader	Ordering code	EKIT-TOTEM-ACC-0017A*
	Features	Shelf kit with BCR 1D/2D reader (w/o keyboard) Compatible with most 1D & 2D barcode USB interface

Choice notice → **The shelf kit can not be chosen in combination with keyboard or barcode kit**

Shelf	Ordering code	EKIT-TOTEM-ACC-0014*
	Features	Shelf kit (w/o keyboard, w/o barcode reader)

* Intended as optional kit





Intercomp S.p.A.
Via della Scienza 27, 37139, Verona, Italia
Tel +39 045-8378411 Fax +39 045-8510539
www.intercomp.it intercomp@intercomp.it

Scan me

The product may differ from the images shown. All registered names and trademarks are legitimate owners. All features and specifications can be changed without prior notice.
Last update 04/05/2020



Mechanical specifications

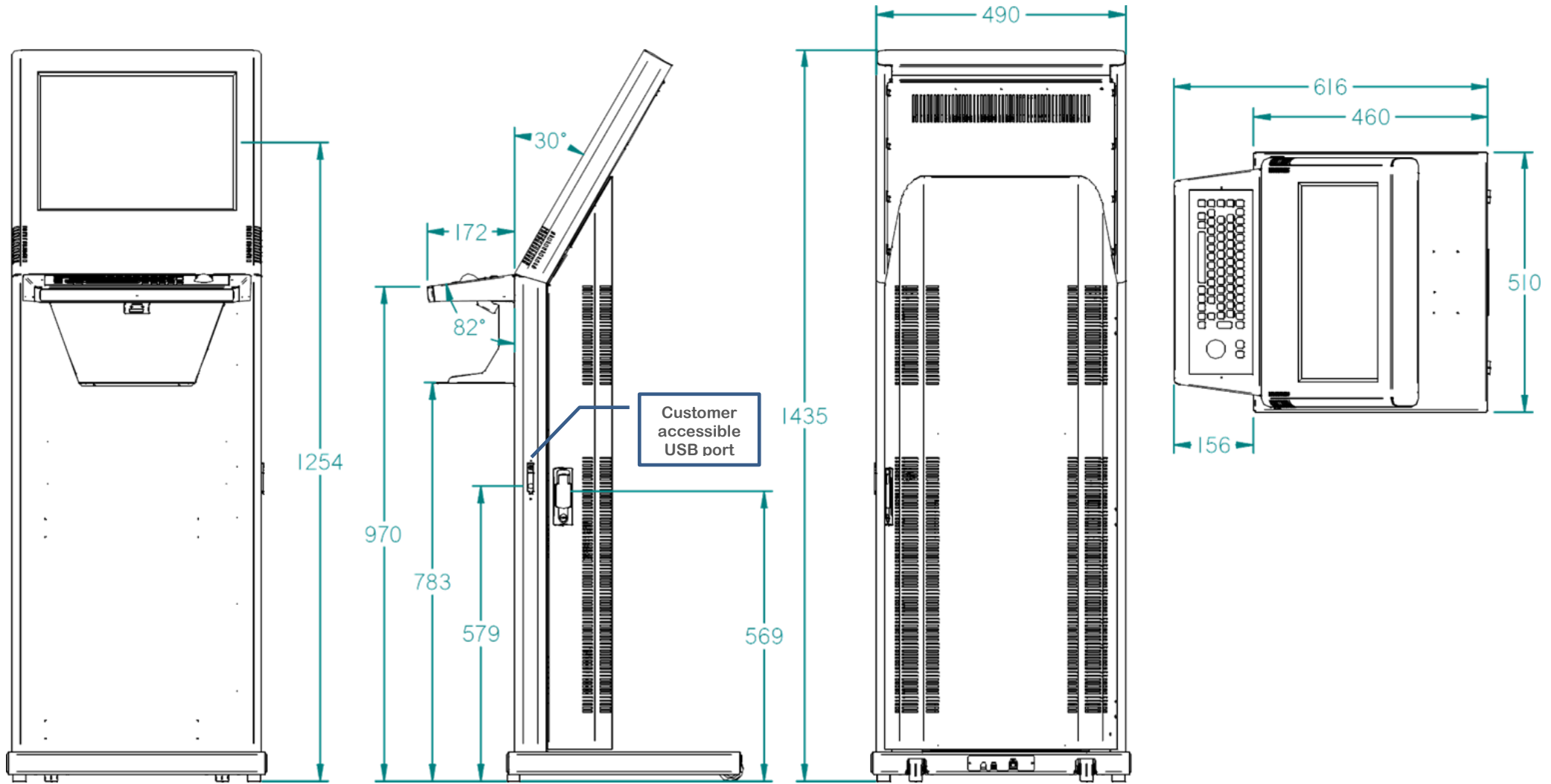



Models overview



w/o keyboard & bcr shelf kit



w/ keyboard & w/o bcr shelf kit



w/ keyboard & bcr shelf kit

